



INTEGRALES



CONSERVADORA GCF



- + MONOCASCO / MONOHULL / MONOCOQUE
- + OPTIMIZACIÓN ESPACIO VENTA / RETAIL FOOTPRINT OPTIMIZATION / RETAIL FOOTPRINT OPTIMISATION
- + VISIÓN PRODUCTO / PRODUCT VISIBILITY / VISIBILITÉ PRODUITS
- CONSUMO / CONSUMPTION / CONSOMMATION

VERSIONES
3L1

GCF

CONSERVADORA INTEGRAL
PLUG-IN ISLAND
CONSERVATEUR GROUPE LOGÉ

-18 / -26°C

-16 / -26°C



CONSERVADORAS GCF	Módulo / Module (mm)				Cuba / Basetray / Cuve	Profundidad / Depth / Profondeur
	170 (1700)	220 (2200)	250 (2500)	195C (1940)		
GCFC	170 (1700)	220 (2200)	250 (2500)	195C (1940)	720 mm	880 mm
GCFCDA	170 (1700)	220 (2200)	-	195C (1930)	695 mm	855 mm
GCFCDA	-	220 (2200)	-	-	800 mm	940 mm

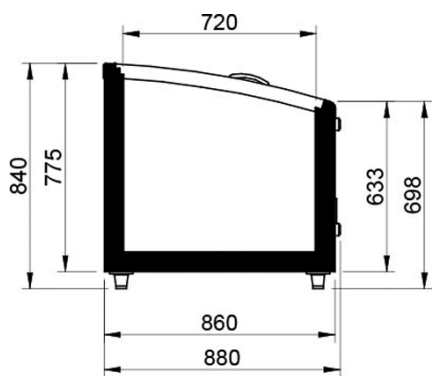
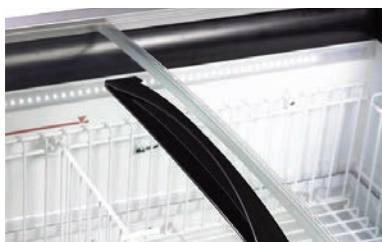

GCFC

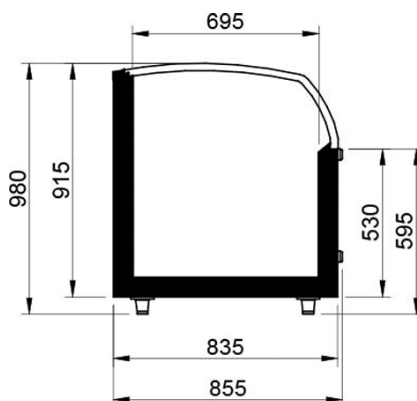

GCFD

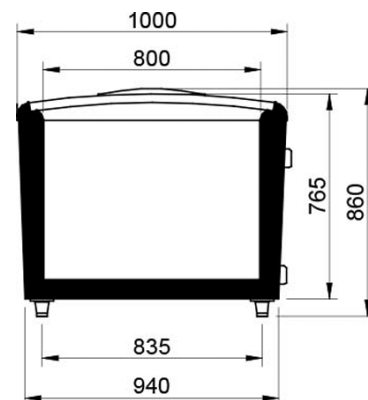

GCFDA

TABLA VOLUMEN NETO
NET VOLUME CHART / VOLUME NET TABLE

CONSERVADORAS GCF	170	220	250	195C
GCFC (dm ³)	532	739	883	574
GCFCD (dm ³)	602	725	-	619
GCFDA (dm ³)	-	833	-	-

TABLA VOLUMEN BRUTO
GROSS VOLUME CHART / VOLUME BRUT TABLE

CONSERVADORAS GCF	170	220	250	195C
GCFC (dm ³)	741	861	1132	623
GCFCD (dm ³)	653	863	-	698
GCFDA (dm ³)	-	934	-	-

PUNTO DE VENTA / IN POINT OF SALE / POINT DE VENTE



Exposición y conservación de alimentos, S.A.

Pol. Industrial El Campillo C/A, nº 1. Ctra. Marcilla-Funes, 31340 Marcilla, Navarra, España (Spain) Telf. (+34)948 708 292 Fax (+34)948 708 293



exkalsa@exkalsa.com
www.exkalsa.es



info@exkalsaconcept.com
www.exkalsaconcept.es

Catálogo conservadora integral GCF ed0.

